



**SALE PENDING**

**Plan:** Abigail

**Elevation:** Trimble Meadows  
Homesite #172 - Move in for \$0\*\*

 **3** Bedrooms

 **3.5** Bathrooms

 **2,139** Sq. Ft.

**New Price Improvement | The Abigail at Trimble Meadows**

**Homesite #172** • 328 Aqua Square, Edgewood, MD

Experience the perfect blend of Craftsman style and expanded living space. This move-in ready Abigail townhome features a **4-foot rear extension on all three levels**, delivering significant extra square footage where it matters most. From the striking stone-accented exterior to the fully finished lower level, every detail of this Sage Home is designed to impress.

**Home Highlights:**

- **Expanded Main Level:** A bright, open-concept floor plan featuring an oversized kitchen island, dedicated dining area, and an expansive great room.
- **Upgraded Upper Level:** Three spacious bedrooms, including a serene owner's suite. Includes the ultimate convenience of bedroom-level laundry.
- **Finished Lower Level:** A flexible recreation room with a full bath—perfect for a home office, guest suite, or hobby space.

**Outdoor Living:** Relax on your large rear deck, accessible directly from the main living area. All square footages are approximate. Relaxing areas and reception areas may vary slightly from the actual home shown in reverse of plans shown, depending on site conditions. Minor architectural changes may be made occasionally at the option of the builder. Please contact your Sales Consultant for details.

Trimble Meadows Homesite #172 - Move in for \$0\*\*



NOTE: All renderings are for illustrative purposes only and not part of a legal contract. Although all illustrations and specifications are believed correct at time of publication, accuracy cannot be guaranteed. The right is reserved to make changes.

MH898 0113



1/24

*Finished Basement Options*

All square footage is approximate. Renderings are artist's conceptions and may vary slightly from the actual home. Homes may be built in reverse of plans shown, depending on site conditions. Minor architectural changes may be made occasionally at the option of the builder. Please contact your Sales Consultant for details.

Trimble Meadows Homesite #172 - Move in for \$0\*\*



All square footage is approximate. Renderings are artist's conceptions and may vary slightly from the actual home. Homes may be built in reverse of plans shown, depending on site conditions. Minor architectural changes may be made occasionally at the option of the builder. Please contact your Sales Consultant for details.

Trimble Meadows Homesite #172 - Move in for \$0\*\*

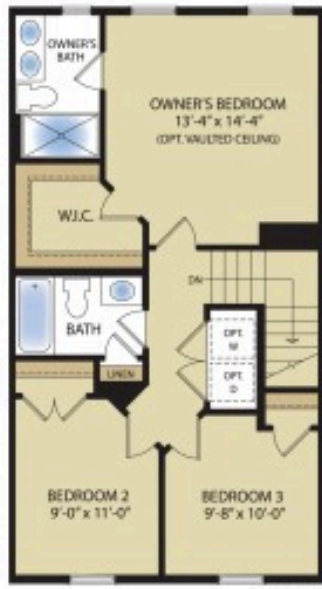

36' SECOND FLOOR



40' SECOND FLOOR

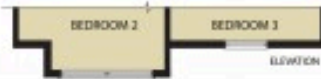

*Second Floor Options*

All square footage is approximate. Renderings are artist's conceptions and may vary slightly from the actual home. Homes may be built in reverse of plans shown, depending on site conditions. Minor architectural changes may be made occasionally at the option of the builder. Please contact your Sales Consultant for details.