



**SALE PENDING**

**Plan:** Abigail

 **3** Bedrooms

 **3.5** Bathrooms

 **2,139** Sq. Ft.

## Extraordinary Value | Move-In Ready with \$0 Down!

**Homesite #174** • 332 Aqua Square, Edgewood, MD

Don't wait on new construction—this stunning **Abigail townhome** is 100% complete, loaded with premium upgrades, and ready for a quick settlement! Boasting striking Craftsman curb appeal with rich stone accents, this layout features a **4-foot rear extension on all three levels**, delivering massive extra square footage exactly where you need it most.

### Home Highlights:

- **The Main Level:** A bright, wide-open floor plan featuring an expansive great room with a cozy fireplace, a dedicated dining area, and an oversized kitchen island perfect for prepping and entertaining.
- **The Upper Level:** Three spacious bedrooms, including a serene owner's suite with a private bath. Enjoy the ultimate convenience of bedroom-level laundry!
- **The Finished Lower Level:** An oversized recreation room with an additional full bath—perfect for a home office, media room, or private guest suite.
- **Outdoor Living:** A large rear deck extending your living space outdoors.

All square footage is approximate. Renderings are artist's conceptions and may vary slightly from the actual home. Homes may be built in reverse of plans shown, depending on site conditions. Minor architectural changes may be made occasionally at the option of the builder. Please contact your Sales Consultant for details.



**Special Financing Incentive**

Trimble Meadows Homesite #174 - 3 Finished Levels - Move in for \$0\*\*



NOTE: All renderings are for illustrative purposes only and not part of a legal contract. Although all illustrations and specifications are believed correct at time of publication, accuracy cannot be guaranteed. The right is reserved to make changes.

MH99 0113



1/24

*Finished Basement Options*

All square footage is approximate. Renderings are artist's conceptions and may vary slightly from the actual home. Homes may be built in reverse of plans shown, depending on site conditions. Minor architectural changes may be made occasionally at the option of the builder. Please contact your Sales Consultant for details.

Trimble Meadows Homesite #174 - 3 Finished Levels - Move in  
for \$0\*\*



All square footage is approximate. Renderings are artist's conceptions and may vary slightly from the actual home. Homes may be built in reverse of plans shown, depending on site conditions. Minor architectural changes may be made occasionally at the option of the builder. Please contact your Sales Consultant for details.

Trimble Meadows Homesite #174 - 3 Finished Levels - Move in for \$0\*\*

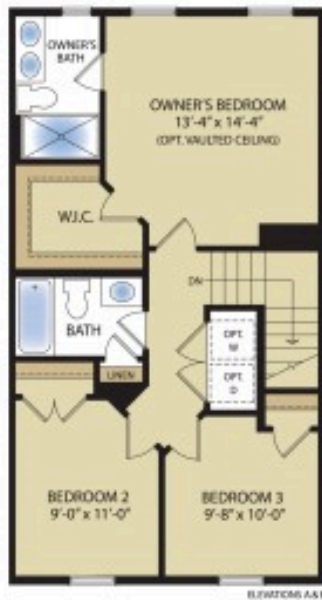

36' SECOND FLOOR

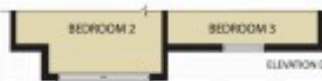

40' SECOND FLOOR



*Second Floor Options*

All square footage is approximate. Renderings are artist's conceptions and may vary slightly from the actual home. Homes may be built in reverse of plans shown, depending on site conditions. Minor architectural changes may be made occasionally at the option of the builder. Please contact your Sales Consultant for details.



Townhome

**Homesite 174 | 332 Aqua  
Square**

Edgewood, MD 21040

Trimble Meadows Homesite #174 - 3 Finished Levels - Move in  
for \$0\*\*

All square footage is approximate. Renderings are artist's conceptions and may vary slightly from the actual home. Homes may be built in reverse of plans shown, depending on site conditions. Minor architectural changes may be made occasionally at the option of the builder. Please contact your Sales Consultant for details.