



Home Priced At  
**\$419,990**

**Plan: Abigail**

-  **3** Bedrooms
-  **3.5** Bathrooms
-  **1,900** Sq. Ft.

## Quick Move-In | Major Price Improvement!

**Homesite #89** • 11258 Davisar Drive, White Marsh, MD 21162

Don't miss your chance to secure a beautifully finished, turn-key Craftsman-style garage townhome in the heart of White Marsh. Loaded with premium upgrades and designed for modern living, this high-demand home is 100% complete and ready for a fast settlement.

### Home Highlights:

- **Spacious Layout:** 3 Bedrooms, 3.5 Baths, and a fully finished lower level.
- **Designer Finishes:** Granite countertops, stainless steel appliances, and upgraded flooring throughout.
- **Bonus Living Space:** A huge lower-level recreation room with a full bath—ideal for guests, a home office, or a media room.
- **Outdoor Living:** A large, private rear deck perfect for morning coffee or weekend BBQs.

Every detail of this home has been carefully curated, and the craftsmanship truly stands out.

**Schedule your tour today, before this opportunity is gone!**

All square footage is approximate. Renderings are artistic conceptions and may vary slightly from the actual home. Homes may be built in reverse of plans shown, depending on site conditions. Minor architectural changes may be made occasionally at the option of the builder. Please contact your Sales Consultant for details.

Vista Reserve - 3 Level, Garage Towns in White Marsh-  
Homesite #89



NOTE: All renderings are for illustrative purposes only and not part of a legal contract. Although all illustrations and specifications are believed correct at time of publication, accuracy cannot be guaranteed. The right is reserved to make changes.

MH89# 0113



*Finished Basement Options*

All square footage is approximate. Renderings are artist's conceptions and may vary slightly from the actual home. Homes may be built in reverse of plans shown, depending on site conditions. Minor architectural changes may be made occasionally at the option of the builder. Please contact your Sales Consultant for details.

Vista Reserve - 3 Level, Garage Towns in White Marsh-  
Homesite #89



*First Floor Options*

All square footage is approximate. Renderings are artist's conceptions and may vary slightly from the actual home. Homes may be built in reverse of plans shown, depending on site conditions. Minor architectural changes may be made occasionally at the option of the builder. Please contact your Sales Consultant for details.

Vista Reserve - 3 Level, Garage Towns in White Marsh-  
Homesite #89

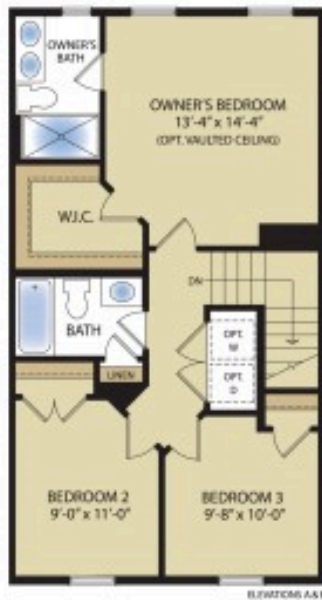

36' SECOND FLOOR



ELEVATION C

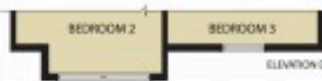

ELEVATION D



40' SECOND FLOOR

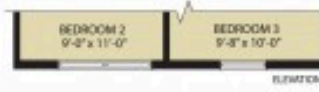

ELEVATION C

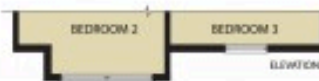

ELEVATION D

*Second Floor Options*

All square footage is approximate. Renderings are artist's conceptions and may vary slightly from the actual home. Homes may be built in reverse of plans shown, depending on site conditions. Minor architectural changes may be made occasionally at the option of the builder. Please contact your Sales Consultant for details.